





- Upper Flat
- Close to Amenities
- Council Tax Band *A*
- Viewing Recommended
- Two Bedrooms
- Shared Yard
- Leasehold
- Call For More Information





**** Video Tour on our YouTube Channel | <https://youtu.be/Yme7JOVR1ZY> ****

This charming, two-bedroom, first floor flat is positioned in a popular location in Wallsend.

Internally the flat briefly comprises: - entrance and stairs to the first floor, spacious lounge, kitchen with fitted wall and floor units, integrated oven and hob and stairs to the rear. There are two good sized bedrooms and a modern, three piece bathroom WC with a shower mixer tap on the bath. Externally, there is a shared yard to the rear.

Wallsend is known for its abundance of parks and green spaces, providing residents with plenty of opportunities for outdoor activities and relaxation. The area also enjoys superb transport links, with nearby Metro stations and excellent road connections, ensuring quick and easy access to Newcastle city centre and surrounding areas. For history enthusiasts, the property is located just a short distance from the Segedunum Roman Fort and Museum, offering a glimpse into the area's rich past.

Early viewings come highly recommended. To book yours or for more information please call our team on 0191 270 1122.

Tenure

The agent understands the property to be leasehold. However, this should be confirmed with a licenced legal representative.

Council Tax band *A*.

First Floor

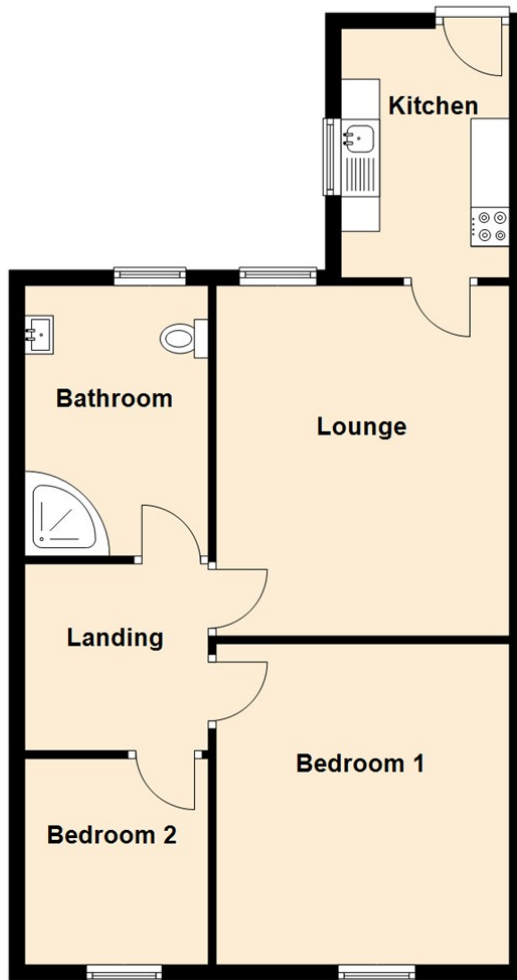

Lounge 14'10" x 12'4" (4.54 x 3.78)

Kitchen 10'7" x 7'0" (3.24 x 2.14)

Bedroom One 12'5" x 13'7" (3.80 x 4.16)

Bedroom Two 8'9" x 7'9" (2.67 x 2.38)

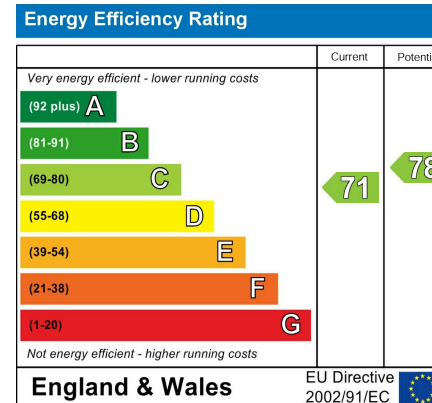

The difference between house and home

You may download, store and use the material for your own personal use and research. You may not republish, retransmit, redistribute or otherwise make the material available to any party or make the same available on any website, online service or bulletin board of your own or of any other party or make the same available in hard copy or in any other media without the website owner's express prior written consent. The website owner's copyright must remain on all reproductions of material taken from this website.



www.janforsterestates.com

Gosforth
High Heaton
Tynemouth
Property Management Centre

0191 236 2070
0191 270 1122
0191 257 2000
0191 236 2680

